

ZEN VILANEIRA

VILANEIRA OÜ

BUILDING MATERIAL

2022
2023



WWW.ZENVILANEIRA.EU

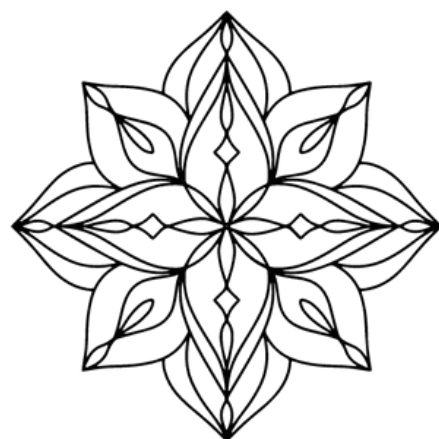

Buildings adorned with a wet plaster facade system offer not only an aesthetically pleasing appearance but also a host of notable advantages.

This particular coating exhibits remarkable resistance against the detrimental impact of precipitation and ultraviolet rays.

Notably, manufacturers assert that this coating can endure for up to three decades, underscoring its durability.

The components of the wet plaster facade system are as follows:

1. Construction base (wall)
2. Adhesive mixture for tile installation
3. Insulation material (maximum thickness: 180 mm)
 - Mineral wool insulation
 - Expanded polystyrene
4. Anchor bolt
5. Reinforcing adhesive mixture for the base layer
6. Fiberglass reinforcing mesh
7. Primer with quartz sand
8. Decorative layer of mineral, polymer, or silicate plaster
9. Base profile (for the base of the wall)

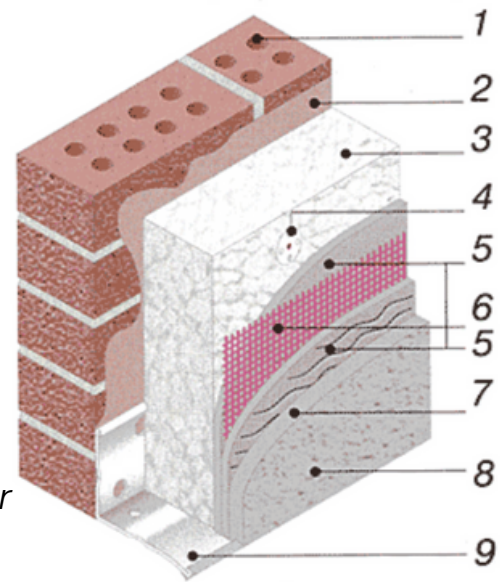

Proficiently executed plaster facade works provide effective shielding for the building's interior, offering protection against noise and cold. By enhancing the structure's thermal insulation properties, it ensures an improved indoor environment. Additionally, it significantly reduces noise levels by half, contributing to a serene atmosphere. The application of plaster facades on buildings evokes a sense of nostalgia, reminiscent of the opulence and grandeur of noble aristocratic residences from bygone eras. However, this finishing material extends beyond its aesthetic appeal, showcasing commendable thermal and sound insulation properties.

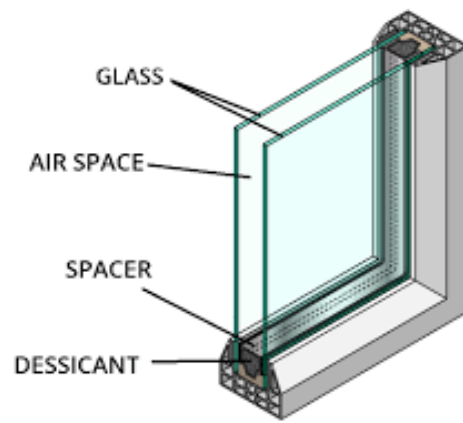

- *Our partners have implemented a strict standard for the windows used in our buildings, exclusively opting for double-glazed windows. This deliberate choice ensures that our structures are equipped with windows that offer enhanced insulation properties, improved soundproofing, and increased energy efficiency. By utilizing double-glazed windows, we prioritize the comfort and well-being of the occupants while promoting sustainable and eco-friendly practices in our construction projects.*

Discover the pinnacle of excellence in construction with Zenvilaneira's esteemed partners. We take immense pride in collaborating with industry-leading professionals who share our unwavering commitment to using only the highest quality materials in every new building project.

With years of expertise and a passion for precision, our partners possess an unmatched understanding of the intricate art of construction. They meticulously select superior materials that meet the most stringent standards, ensuring durability, longevity, and impeccable craftsmanship in every aspect of the building process.

From the foundation to the finishing touches, our partners' unwavering dedication to quality and care is evident in every detail. With an unwavering focus on excellence, they strive to create structures that surpass expectations, embodying a timeless blend of functionality, aesthetics, and sustainability.

Building with Zenvilaneira and our esteemed partners means embarking on a journey where uncompromising quality is the cornerstone. Trust in our collaborative expertise and experience the satisfaction of owning a meticulously crafted masterpiece, built with the utmost dedication to delivering the finest construction in every square inch.

